

GLOWPAD112 RGB LED Video Light Manual

Thanks for choosing GLOWPAD112 RGB LED video light. The GLOWPAD112 LED video light uses integrated RGBW LED chips. It produces diffused, glowing light, with high luminous efficiency, long life, outstanding color rendition. Meanwhile it has a variety of effects functions, and can be controlled by mobile phone APP.

I Product Structure

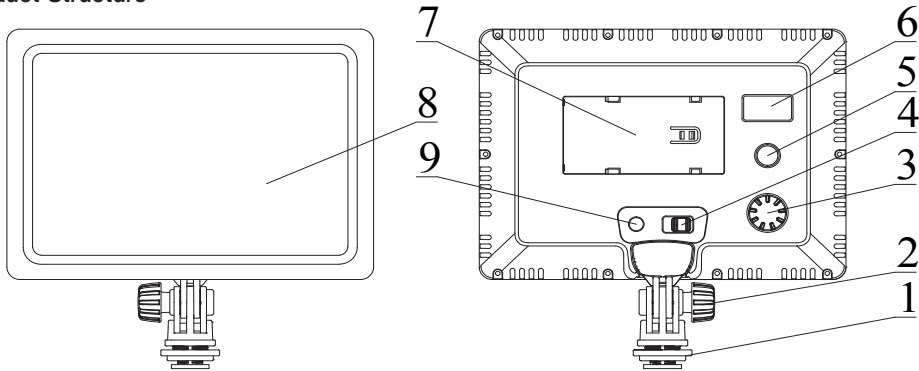

1	Hot shoe and lock nut	2	Tilt Bracket Lock	3	Control Dial
4	Power Switch	5	Mode Button	6	LCD display
7	Battery Plate	8	LED light panel	9	Power input socket

II Product Specification

Light Source	60 LED chips	Mobile phone APP	Yes		
Max Power	15W	Remote distance	>10m		
CCT	2800-8000K	Mode switch	CCT/HSI/GEL/EFX/SET		
CRI	95%	Master/ Slave	Yes		
Brightness (Lux@1m)	140	Color Brightnes (Lux@1m)	R	G	B
			58	102	22
Housing size	175x172x30mm	Weight	305g		

III Method of Application

Power input

a. Battery input: Compatible batteries: Sony NP-F series.

Mount lithium battery: Please install battery in accordance to what is shown in the diagram.

Removing lithium battery: please take out of battery in the opposite direction.

b. DC adapter input: Use 9V/2.5A DC power adapter (selective). *Attention: Do not use the battery and DC input at the same time!*

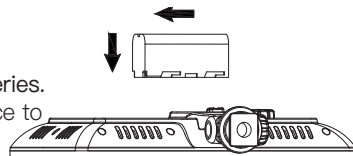

LED video light Installation

a. Fixed to SLR cameras/camcorders hot shoe: Insert the LED video light into the SLR cameras, camcorders hot shoe, tighten the locking nut (1).

b. Fixed to Light Stand/Tripod: Screw the 1/4 inch thread which at the bottom of the LED video light hot shoe base to light stand/tripod directly.

3. Operation

Turn on the Power switch (4) to turn the light on. Press Mode button (5) to select light mode.

3.1 CCT mode

Press Mode button (5), to enter "CCT" mode on the upper left corner of the screen. Press in the control dial (3) to select parameter on screen. Rotate control dial (3) to adjust CCT or brightness.

- ① Power adjustment
- ② Color temperature adjustment
- ③ Mode -CCT mode
- ④ Group No.
- ⑤ Light No.
- ⑥ Master/Slave
- ⑦ Battery indicator

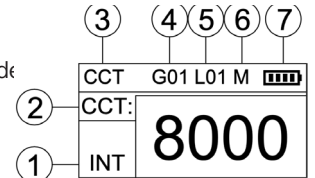

3.2 HSI mode

Press Mode switch (5) enter "HSI" mode on the upper left corner of the screen.

Press Control Dial (3) to select parameter on screen. Rotate Control Dial (3) to adjust Hue, Saturation and Intensity.



3.3 GEL Mode

Press Mode switch (5) enter "GEL" mode on the upper left corner of the screen.

Press the Control Dial (3) to select parameter on screen. Rotate Control Dial (3) to select the corresponding "GEL" mode and Intensity.

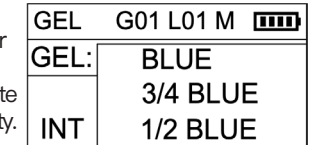

3.4 EFX mode

Press Mode switch (5) enter "EFX" mode on the upper left corner of the screen.

Rotate (3) to select corresponding "EFX" mode.

Press the Control Dial (3) to turn on or turn off "EFX" mode.

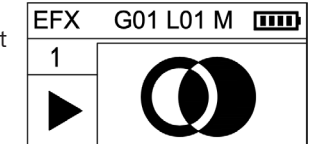

3.5 SET mode

Press Mode switch (5), enter "SET" mode on the upper left corner of the screen. Rotate Adjust button (3) to select corresponding "SET" parameter. Press Adjust button (3) to select corresponding "SET".

- A) G # Mode:Set Group No of each light.
- B) L # Mode:Set light No of each light.
- C) M/S Mode

MASTER: Transmitter and receiver to control same group lights. When adjust light parameter in one group, can synchronously change all lights to the same parameter in the group. When adjust main light and transmitter in the same time, other group lights synchronously change.

SLAVE: Only receiver to control same group lights. When adjust Master light parameter in one group, can synchronously change all lights to the same parameter in the group.

NONE: When there is NONE Mode on the LCD display, means turn off Master/Slave mode.

- D) LAG:Select system language.
- E) RFD:Select whether to restore factory settings.
- F) VER:Display the current system version.



Download mobile phone software "PIXAPRO" to control light. You may simply search "PIXAPRO" on AppStore or Google Play Store to download the APP. Or you may scan the QR code beside to download the APP.

3.6 Power indicator

The LCD display shows power indicator ⑦. If battery is low, the power indicator decrease. When there is only one grid on indicator, battery needs to be recharged

4. Disposal (end of life)

In order to minimize hazards to health and the environment and ensure that materials can be recycled, this product should be disposed of at a separate collection facility.

IV Attention

1. Do not cover light body in case effecting thermal dissipation.
2. Keep clean, turn off the light when cleaning.
3. After using, keep the light in a safe and dry place.
4. Do not keep the light in sunlight or in high temperature.
5. Do not use solvents, gasoline, paints and pesticides in the product.
6. Do not insert metal objects into lamp housing.
7. Do not attempt to repair the light. If there are some problems, turn off the light and contact your dealer or our company.

V Attention

1 Light body

2 Manual

VI Troubleshooting

Description	Cause	Trouble-shooting
No reaction after power on	Dimmer Dial on 0%	Rotate dimmer dial clockwise
	Power adapter not match	Use standard adapter
	Low battery	Charge the batteries before use
	Circuit board damaged	Return factory for repair
Battery power test inaccurate when power switch is on, Display low battery when you increase the brightness	Battery capacity shown indicated the length of time available for use in the current luminance	Normal
LCD error or backlight off	LCD display damage	Return factory for repair

FCC Statement:

This device complies with Part 15 of the FCC Rules. Operation is subject to the following two conditions:

- (1) This device may not cause harmful interference, and
- (2) This device must accept any interference received, including interference that may cause undesired operation. Warning: Changes or modifications not expressly approved by the party responsible for compliance could void the user's authority to operate the equipment.

NOTE: This equipment has been tested and found to comply with the limits for a Class B digital device, pursuant to Part 15 of the FCC Rules. These limits are designed to provide reasonable protection against harmful interference in a residential installation.

FCC Radiation Exposure statement:

This equipment complies with FCC radiation exposure limits set forth for an uncontrolled environment. This equipment should be installed and operated with minimum distance 20cm between the radiator & your body.