

With speedlite softbox



With Bowens-mount softbox



With reflector



▲ With snoot



◀ With photo umbrella



▶ With beauty dish

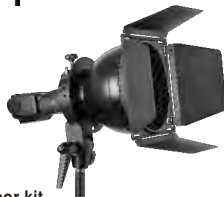

▶ With barndoor kit

S-type Speedlite Bracket & EL Fitting Speedlite Bracket



▶ S-EL Speedlite Bracket (Elinchrom mount)

▶ S-type Speedlite Bracket (Bowens mount)

Operation Guide

Take the S-type Speedlite Bracket (Bowens mount) as an example :

- Fix the flash body.

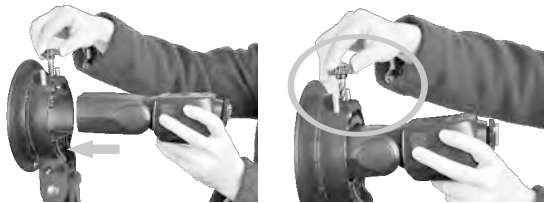

- Loosen screw of the handle for adjusting bracket direction.

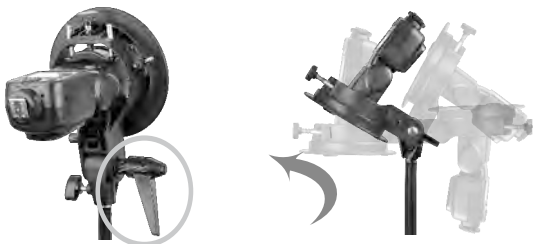

- Mount speedlite softbox

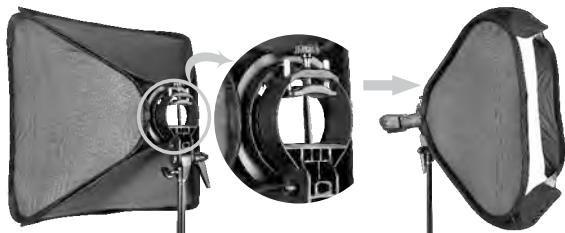

- Mount Bowens-mount accessories



- Mounted Horizontally

- Mounted Vertically



- Fit for size-variable speedlites and barebulb flashes

